



CLARA

CLA | SUSPENDED, WALL, SURFACE

STANDARD SIZES

4.75" Hollow Lensed Body
Configurable in 2ft increments (suspended mount)
ADA-Compliant 2ft/4ft wall sconce

LAMPING

LED - 80/90 CRI - 2700K/3000K/3500K/4000K
Dimming down to 0%

FINISH

18 standard finishes available at no extra charge
RAL classic colors, TCI / Tiger Drylac catalog colors, and custom color
match also available

CONSTRUCTION

Industrial Strength Extruded 6061 Aluminum Housing
Extruded, Impact-Resistant Acrylic Lensed Body





PRODUCT SUBMITTAL WORKSHEET

SAMPLE PRODUCT CODE

CLA – S6 – LED/3500 – 0/10V/0% – SFR – AL – UNV – EMB/1 – OS/1 – COMBO – SB
1 2 3 4 5 6 7 8A 8B 8C

1. BASE MODEL (CHOOSE ONE)

- CLA** 4-3/4" Suspended, 52% direct / 48% indirect
 CLAW 4-3/4" Wall Sconce, 52% direct / 48% indirect (may be mounted vertically or horizontally)

2. LENGTH (ENTER LENGTH IN FEET)

S__ Individual/Straight Run Section (enter length in 2ft increments for suspended mount or choose 2ft or 4ft for wall mount, ex. S6)

*CLA models are available in continuous rows of joined individual sections that are powered separately. Lenses are not continuous, joiners are used to connect sections. CLAW models are available in 2ft and 4ft individual sections.

*Lengths are nominal and may vary based on lamping and other specification selections. Consult ALW when exact lengths are required.

4. LED LAMPING (CHOOSE ONE)

- LED/2700K** 80 CRI only, 2700K CCT (very warm)
 LED/3000K 80/90 CRI, 3000K CCT (warm)
 LED/3500K 80/90 CRI, 3500K CCT (slightly warm)
 LED/4000K 80/90 CRI, 4000K CCT (neutral)

| DELIVERED LUMENS (LM/FT) | WATTS (W/FT) | EFFICACY (LM/W) |
|--------------------------|--------------|-----------------|
| 522 | 10.9 | 89 |

*Based on data at 4000K using an SFR lens and 0/10V/S driver.

5. REMOTE DRIVER^{1,2} (CHOOSE ONE)

- 0/10V/S** 0-10V dimming down to 5% (Standard Dimming)
 0/10V/1% 0-10V dimming down to 1%
 0/10V/0% 0-10V premium dimming down to 0%
 ECOSYS1 (LDE1) Lutron Hi-Lume 1% EcoSystem LED driver with Soft-on, Fade-to-Black dimming technology
 DALI DALI flicker-free dimming down to 0%
 DMX DMX flicker-free dimming down to 0%

¹Driver specifications provided upon request to assist with control system integration

²See more information for compatible Driver under 'Sensor Options' for Lutron Vive Control Systems.

5. LENS (CHOOSE ONE)

- CLR** Clear, extruded acrylic-lensed body (subtle striations may be visible, see pg. 7 for more details)
 SFR Semi-frosted (2%), extruded acrylic-lensed body (see pg. 7 for lensed body descriptions and distinctions)

SS051221-A.0



6. FINISH (CHOOSE ONE. SEE PAGE 6 FOR LARGER SWATCHES AND ADDITIONAL INFORMATION)

STANDARD FINISHES

ALUMINUM

- AL** Anodized Aluminum

BASIC POWDER COAT

- GW** Gloss White
 SW Satin White
 AW  Antimicrobial Satin White
 TW Textured Matte White
 TB Textured Matte Black

METALLIC POWDER COAT

- SG** Silver Gray
 CG Charcoal Gray
 CU Copper
 BR Brass



SATIN ANODIZED EFFECT POWDER COAT

- CS** Clear Silver
 OB Oil-Rubbed Bronze
 DB Dark Bronze
 SB Satin Black

GLOSS POWDER COAT (80-95% GLOSS)

- GO** Orange (RAL 2003)
 GR Red (RAL 3020)
 GM Magenta (RAL 4010)
 GB Blue (RAL 5015)

SPECIAL ORDER FINISHES

- RAL**_____  Specify RAL Classic Color (Ex: RAL 3003) - Most RAL Colors are available for powder coat. See www.alwusa.com/finishes
 CAT_____  Specify Catalog Colors - Specify colors from the [Tiger Drylac](#) and [TCI](#) catalogs
 CCM_____  Custom Color Match - Specify a custom powder coat color match

7. VOLTAGE (CHOOSE ONE)

- UNV** Universal Voltage (120VAC-277VAC)
 347 347 Volt (*Driver options may be limited. Not available with EMB*)

8. ADDITIONAL OPTIONS (OPTIONAL — CHOOSE ONE UNDER A, B, AND ANY UNDER C, IF DESIRED)

A. EMERGENCY OPTIONS

- EMB**/___³ Emergency Battery (*indicate QTY — each battery powers 4ft. section @ 1492lm. Not available in 347V*)
 EMC/___³ Emergency Circuit (*indicate QTY of 4ft sections to be illuminated by emergency circuit*)

³For fixtures under 4ft in length, entire fixture will be illuminated with a proportional lumen output. Consult ALW for more details.

B. SENSOR OPTIONS (DEFAULT QUANTITY IS 1 SENSOR PER 8FT, INDICATE ALTERNATE QUANTITY IF DESIRED)

- FCJS**/___⁴ Lutron® Vive remote RF wireless fixture control (Lutron Part: FCJS-ECO or FCJS-010)
 FCJS/S/___⁴ Lutron® Vive remote RF wireless fixture control + daylight/occ sensor (Lutron Part: FCJS-ECO or FCJS-010, & FC-Sensor)
 ENLGHT/___⁵ Enlighted® remote connected lighting smart sensor (Enlighted Part: SU-5S-H) (*occupancy, daylight, networking, and more*)
 OS/___ 0-10V remote occupancy sensor
 PH/___ 0-10V remote photocell/daylight sensor

⁴Lutron® Vive remote sensors are compatible with the following drivers: 0/10V/S, 0/10V/1, 0/10V/0 driver or ECOSYS. Programming required by Lutron Commissioner.

⁵Enlighted® sensors are compatible with the following drivers: 0/10V/S, 0/10V/1, 0/10V/0. Programming required by Enlighted Commissioner. Additional Enlighted sensor families included IoT Sensors and Enlighted One Sensors are also available. Contact Customer Support for more information.

C. ADDITIONAL OPTIONS (COMPATIBLE ONLY WITH SUSPENDED MOUNT)

- COMBO** Combination 4.5" canopy at power feed locations to accommodate both power cord & suspension mount hardware.
 SB Seismic Bracing

SS051221-A.0



MECHANICAL DIAGRAMS – DIMENSIONS

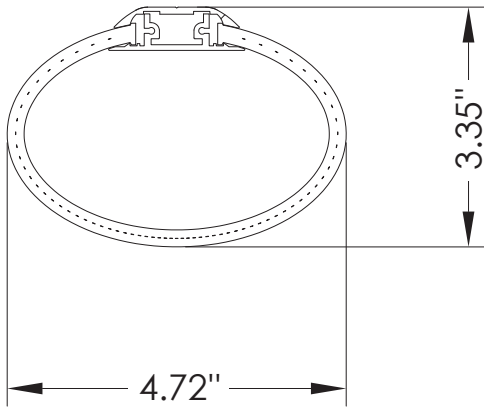

CROSS-SECTION

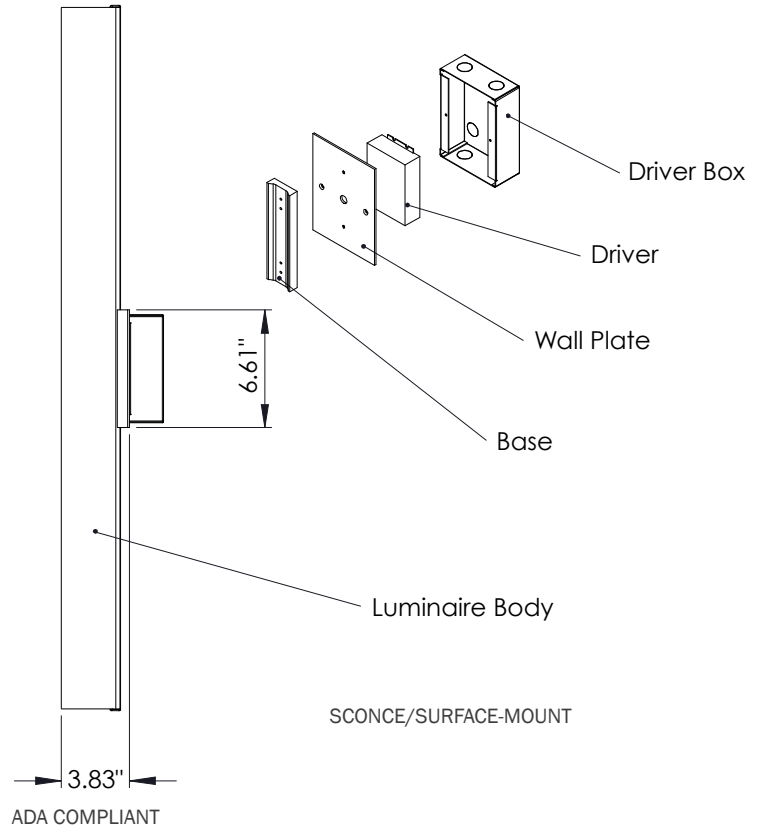

MECHANICAL DIAGRAMS – MOUNTING

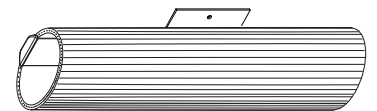
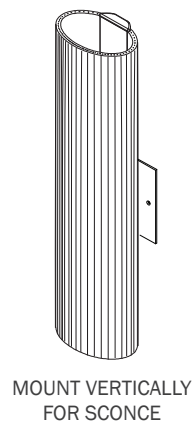
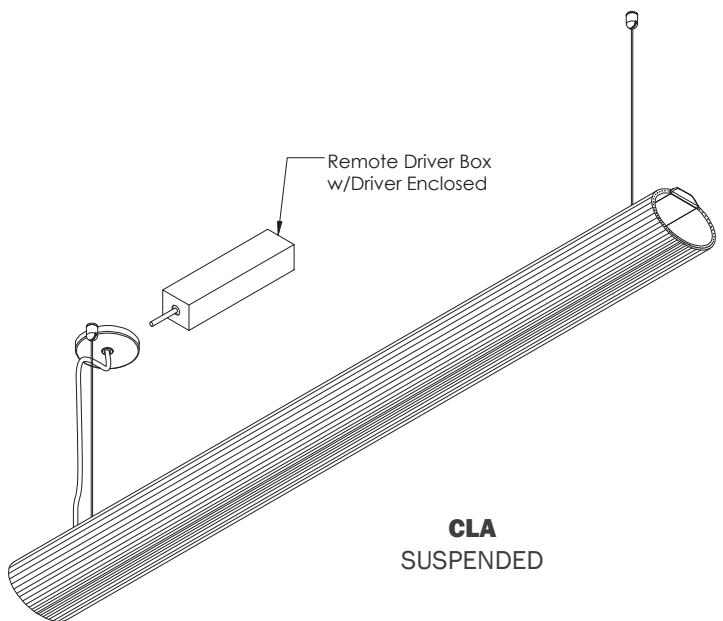

CLAW
SURFACE-MOUNT DIRECT



MOUNTING DETAILS



CEILING HARDWARE

- (1) 4.5" canopy per power feed location,
- (1) bullet mount,
- (1) 10' aircraft cable
- (1) 2" canopy (for use with T-bar mounting) per suspension point

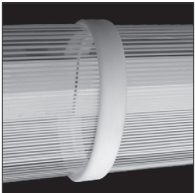

JOINER

For suspended models, a white joiner is provided to connect the luminaire sections together to form a continuous row. NOTE: each section is powered by a separate power feed.



COMBO CANOPY

Choose option COMBO to specify 4.5" canopies at feed locations with power feed and aircraft cable suspension mounting.

Canopy finish is always white. Contact ALW for alternate colors.

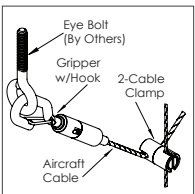

SEISMIC BRACING

Add-on hardware includes cable gripper with hook, 2-cable clamp and specified length of aircraft cable per suspension point.



SURFACE MOUNT HARDWARE

CLAW wall models come with a thin 1/2" wall bracket and plate, making the sconce ADA compliant.

CLARA VOLTAGE DROP CHART FOR REMOTE DRIVERS - WHITE LED, 30VDC

For best performance, ensure proper wire gauge is installed between the remote LED driver and canopy that is dropping power to your fixture. There is one remote driver for every 4ft (e.g. 4ft will have 1 remote driver, but 6ft and 8ft will have 2 remote drivers). This chart only applies to Clara at 30VDC. Do not use this chart to calculate voltage drop for other fixtures.

| WIRE GAUGE | 2ft Section 11.8W 0.39A | 4ft Section 23.6W 0.79A |
|------------|-------------------------------|-------------------------------|
| 18 AWG | 171 ft. | 81 ft. |
| 16 AWG | 276 ft. | 134 ft. |
| 14 AWG | 445 ft. | 218 ft. |
| 12 AWG | 712 ft. | 352 ft. |
| 10 AWG | 1137 ft. | 564 ft. |

SS051221-A.0



STANDARD FINISHES

Standard finishes are available at no additional charge.

ALUMINUM



Anodized Aluminum

BASIC POWDER COAT



Gloss White

Satin White

Antimicrobial Satin White

Textured Matte White

Textured Matte Black

METALLIC POWDER COAT

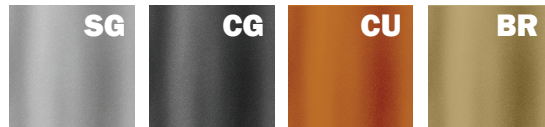

Silver Gray

Charcoal Gray

Copper

Brass

SATIN ANODIZED EFFECT POWDER COAT



Clear Silver

Oil-Rubbed Bronze

Dark Bronze

Satin Black

GLOSS POWDER COAT (80-95% GLOSS)



Orange RAL 2003

Red RAL 3020

Magenta RAL 4010

Blue RAL 5015

SPECIAL ORDER FINISHES*



RAL CLASSIC COLORS (80-95% GLOSS): RAL_ _ _ _

Most RAL Classic Colors are available for a minimum setup fee. On your specification submittal choose your RAL color by entering the 4-digit RAL code (Ex: RAL 3003). See www.alwusa.com/finishes



CUSTOM COLOR MATCH: CCM_ _ _ _

Custom powder coat color matching is available for a premium setup fee. Consult ALW for additional information.



CATALOG COLORS: CAT_ _ _ _

The complete range of powder coat colors from Tiger Drylac and TCI catalogs are available for a minimum setup fee. Consult ALW for a catalog color you would like to specify.

*An individual setup fee will apply to each unique Special Order Finish per purchase order. (ex: RAL 5023 and RAL 2008 are specified for multiple line items on a purchase order. 2x setup fees will apply)



ADDITIONAL OPTIONS & SPECIFICATIONS

ELECTRICAL PERFORMANCE

Class 2 LED drivers. $L_{70} > 54,000$ hours.
80+ CRI. Luminous flux +/- 5%.

LENSED BODY OPTIONS

Extruded, impact-resistant acrylic.

The CLR lensed body is clear acrylic. NOTE: In the CLA suspended model, this clear option produces a faint striation pattern on direct- and lateral-facing surfaces within 12ft of the luminaire. There is no striation pattern on wall surfaces with the CLAW wall sconce.

The SFR lensed body is a semi-frosted (2%) acrylic. This option produces smooth, even illumination (no striation pattern) on all surfaces at all distances in both models, making it an ideal choice for general area lighting applications.

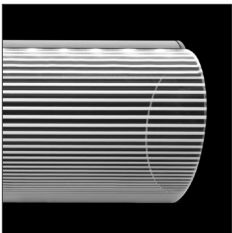

CLR (Clear Lens Body)

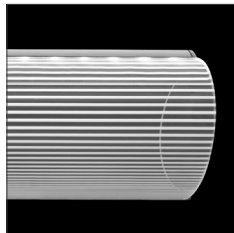

SFR (Frosted Lens Body)

HOUSING

100% recyclable, extruded architectural grade 6061 aluminum with a 0.08" minimum wall thickness.

SAFETY & REGULATORY

ETL Listed (U.S. & Canada).
Conforms to UL std. 2108, Low Voltage Luminaires / Low Voltage Lighting Systems
Certified to CSA std. C22.2#250.0:2008 Ed. 3+G1;G2.

OPERATING CONDITIONS

Luminaire should be installed and operated ONLY in locations where the ambient temperature ranges from -4 °F to 122 °F (-20 °C to 50 °C). Luminaire operation in environments outside the listed temperature range voids the warranty AND may damage the product or adversely impact lamp life, lumen output and color consistency.

POWER CABLES

Power cables come standard in a transparent sheathing to match steel aircraft suspension cables. Please contact customer support if custom cables are required for your application. Power cables cannot be swapped in the field as it will void the ETL Safety Listing and Product Warranty.



CONTROLS, SENSORS, & LED DRIVER

ALW lighting fixtures are intended for use with a wide range of sensors, lighting controls, LED drivers, and building management systems. Our component portfolio is continually expanding to adopt to the latest technologies and specification needs. We currently support integration with Lutron, Enlighted, EldoLED, nLight, Osram, Philips, and more. If there's a component or system needed that you don't see on the spec sheet please contact ALW customer support today so we can review your requirements.

WARRANTY

Limited 5-year warranty. Details: alwusa.com/warranty